

M. G. A. (SCIMS)

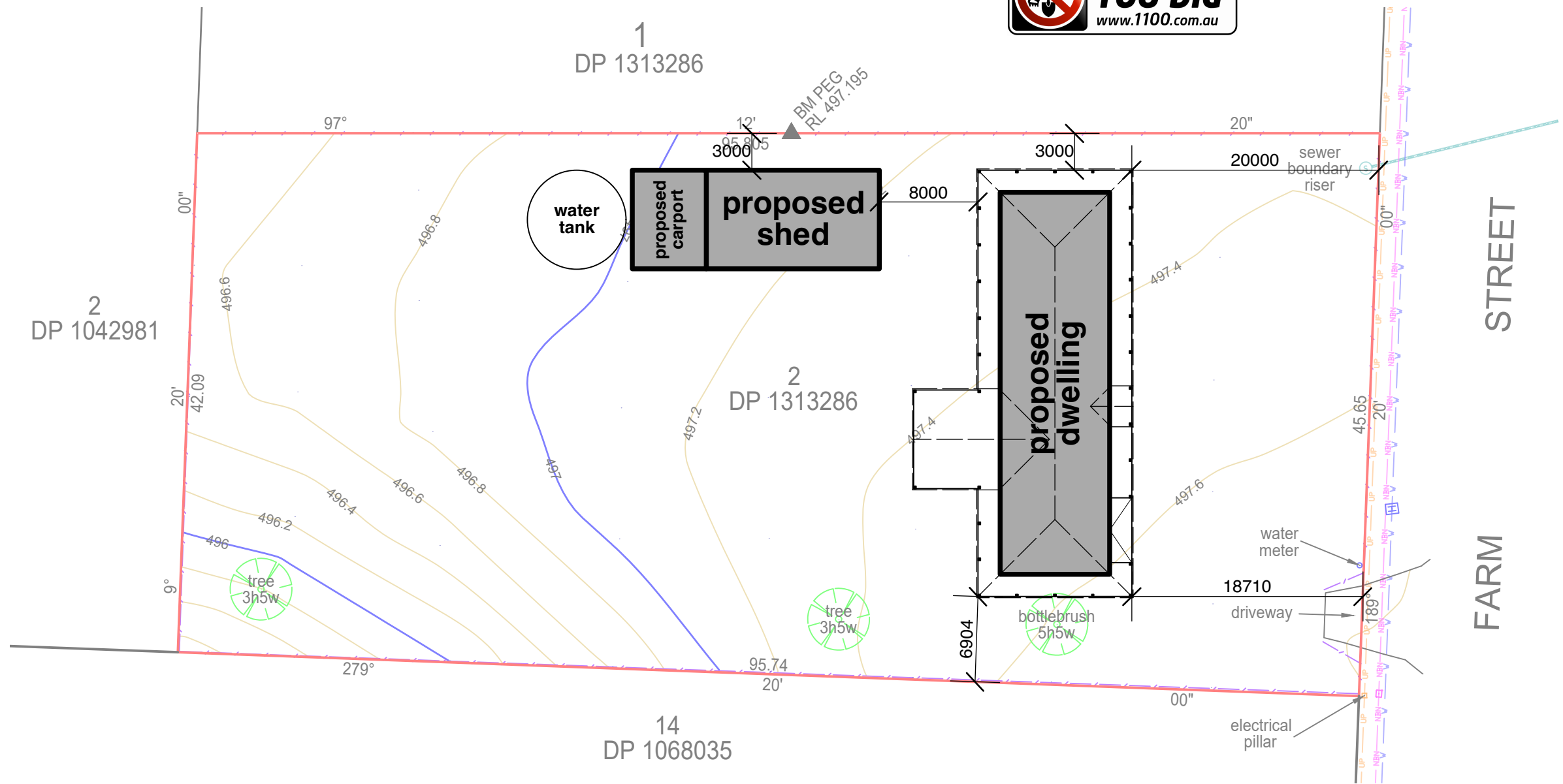

GENERAL NOTES	AREAS
SANITARY DRAINAGE TO BE CONNECTED TO THE SEWER MAIN TO COUNCIL REQUIREMENTS.	SITE AREA4200 sq.m
ALL TIMBER FRAMING SHALL COMPLY WITH THE NCC, ALTERNATIVE STRUCTURAL FRAMING SHALL BE TO STRUCTURAL ENGINEER'S DETAILS AND CERTIFICATION.	FLOOR AREA275 sq.m
REFER TO ENGINEER'S DRAWINGS FOR STRUCTURAL DETAILS.	TERRACE AREA56 sq.m
CONTOURS INDICATED ARE EXISTING.	VERANDAH AREA142 sq.m
THE BUILDING WORKS SHALL BE CONSTRUCTED IN ACCORDANCE WITH THE REGULATIONS AND IN PARTICULAR THE PERFORMANCE REQUIREMENTS REFERRED TO IN THE NCC, HOUSING PROVISIONS, VOLUME 2, AND ANY CONDITIONS IMPOSED BY THE RELEVANT DEVELOPMENT CONSENT OR COMPLYING DEVELOPMENT CERTIFICATE, AND COMMITMENTS OUTLINED IN THE BASIX CERTIFICATE.	DETACHED GARAGE AREA160 sq.m

LEGEND	
	122 major contour
	122.6 minor contour
	UP underground powerlines
	water main
	telecommunications
	fence
	sewer main
	hydrant
	telstra lid

site  
PLAN



All dimensions and floor areas are to be verified by the Builder prior to the commencement of any building work.  
Any discrepancies are to be brought to the attention of the designer.  
Levels shown are approximate unless accompanied by reduced levels.  
Figured dimensions must be taken in preference to scaling.  
All boundary clearances must be verified by the surveyor prior to the commencement of any building work.  
Where engineering drawings are required such must take preference to this drawing.  
All services to be located and verified by the Builder with relevant authorities before any building work commences.  
Copyright: This design and the associated documents is subject to copyright laws and may not be reproduced in any form without written consent from Design Matters.

Issue	Date	Revision / Submission
A	29/04/2025	Issued for Development Application

PROPOSED DWELLING  
AT LOT 2, DP 1313286  
117 FARM STREET, BOOROWA NSW 2586  
FOR MR BAIRD

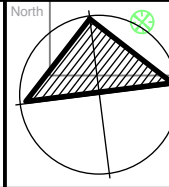

tree type 24111	Drawn MS	Sheet No 02
Scale 1:400	Paper Size A3 Sheet	No. of Sheets 08
Date 29 April 2025	Drawing Title Site Plan	Issue A